

# Basic Detail Report

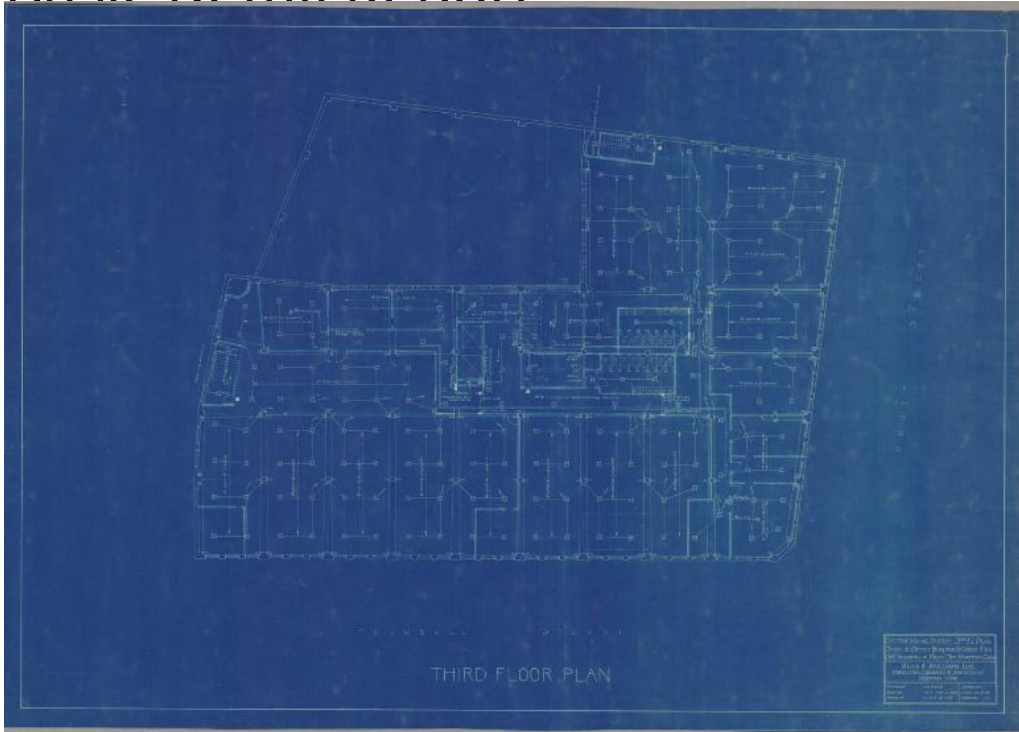

**Title Store Building for Moses Fox Corner Trumbull & Pratt St.**

**Hartford, Conn.**

Date February 21, 1925

Primary Maker Buck & Sheldon, Inc.

Medium Blueprints; cyanotypes on paper

Description Plans for a store include Basement, First Floor, Second Floor, Third Floor, and Fourth Floor Plans with diagrams for electric wiring system. Boilers, a utility room, transformers, details of meter panels, and a typical detail of a telephone terminal box are shown on plans.

Dimensions Primary Dimensions (height x width): 28 1/2 x 40 1/2in. (72.4 x 102.9 cm)