

# Basic Detail Report

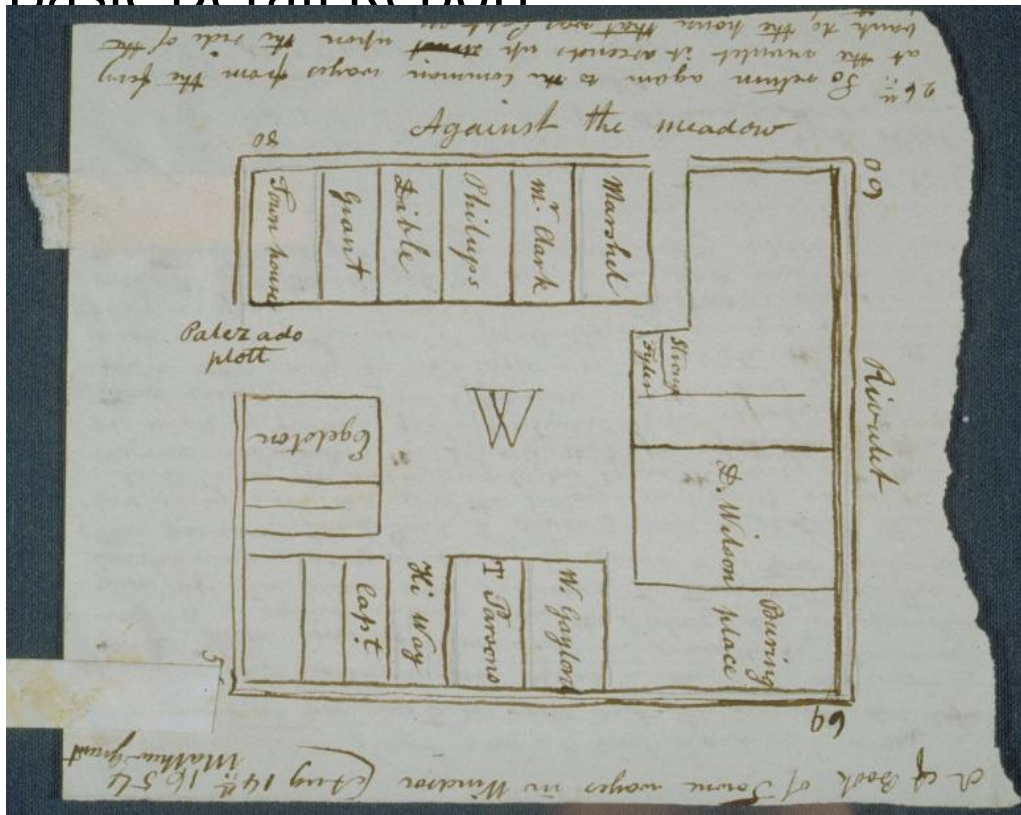

## Title Plan of the ancient Palisado Plot in Windsor.

Date 1835

Primary Maker John Warner Barber

Medium Drawing; pencil on paper

Description Schematic diagram showing the layout of the town of Windsor in

1654 copied by Barber from "A book of Towne Wayes in Windsor" by Matthew

Grant (1601-1681). The plots are inscribed "D. Wilson" "Burying place" "W.

Gaylord" "t. Parson's" "Hi Way" "Capt." "Egelston" "Town house" "Grant"

"Dible" "Philups" "Mr. Clark" "Marshall" "Fyler" "Strong." Beyond the palisade

on one side is the inscription "Against the meadow; "" on the adjoining side

"Rivulet."

Dimensions Primary Dimensions (overall height x width): 5 1/2 x 6 11/16in. (14 x

17cm)