

Basic Detail Report

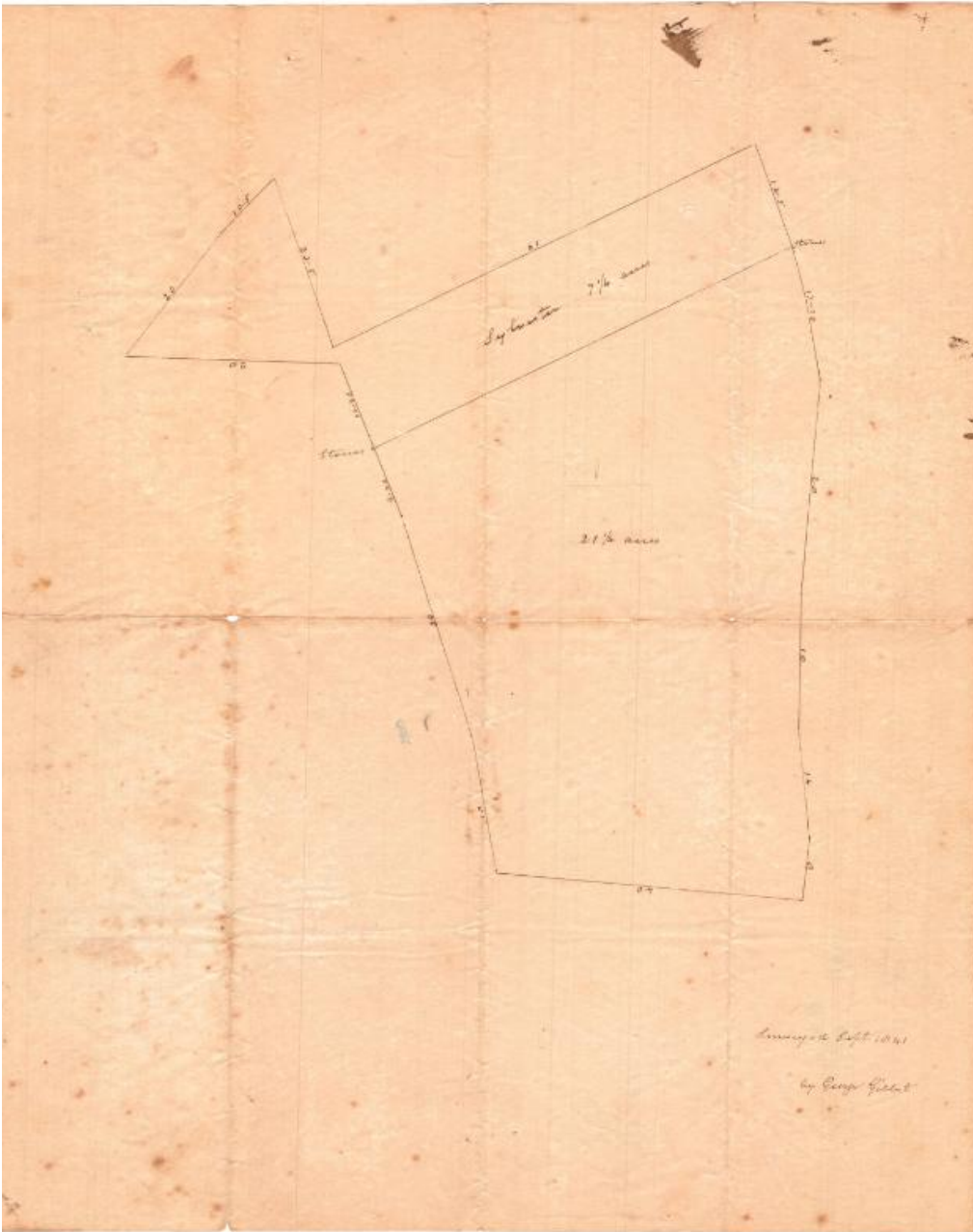

Title Lot survey

Date 1841

Primary Maker George Gillet

Medium Drawing; black ink on wove paper

Description Manuscript survey of two lots of land, presumably located somewhere in Connecticut, although there is no identifying information to

Basic Detail Report

indicate the location. The top lot is labeled "Sylvester", and its area in acres and length in an unknown unit of measurement. The bottom plot of land is not labeled with a name but contains similar measurements.

Dimensions Primary Dimensions (image height x width): 15 7/8 x 12 7/8in. (40.3 x 32.7cm) Sheet (height x width): 15 7/8 x 12 7/8in. (40.3 x 32.7cm)