

Basic Detail Report

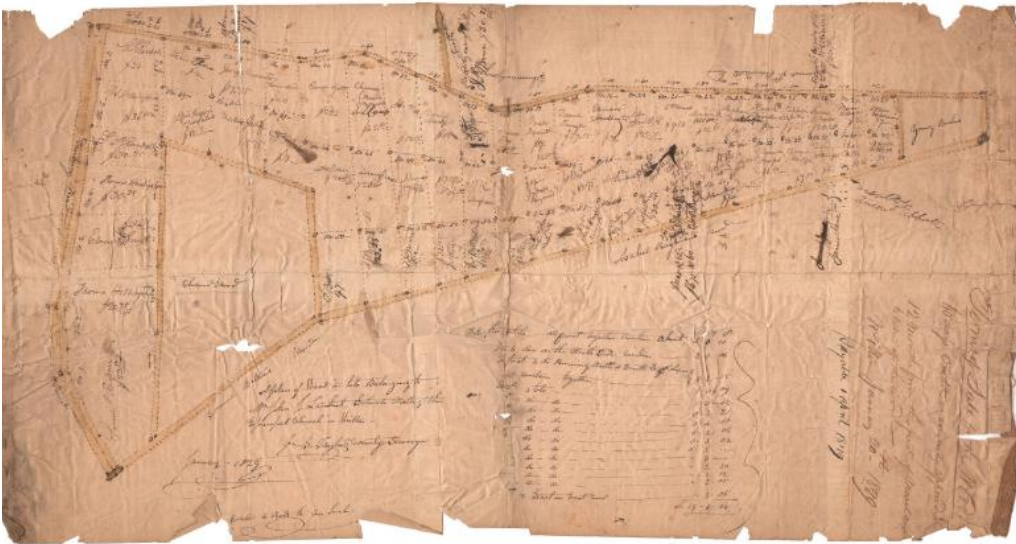

Title A plan of Wood in lots Belonging to Mr. John L. Lambert, Situate North of the Episcopal Church in Wilton

Date 1829

Primary Maker John S. Taylor

Medium Drawing; black ink and watercolor on wove paper, linen strips on side edges

Description Map of 61 land lots in Wilton, Connecticut, up for sale in 1829 for the wood they contained. Each lot is numbered, contains what is presumably the name of the purchaser, and the price for which it sold. In a list below the map, the sizes of the lots in acres, rods and perches. On the right side near the edge the terms of the sales are listed, including when the wood had to be removed.

Dimensions Primary Dimensions (image height x width): 15 3/8 x 29in. (39.1 x 73.7 cm) Sheet (height x width): 15 3/8 x 29in. (39.1 x 73.7cm)