

# Basic Detail Report

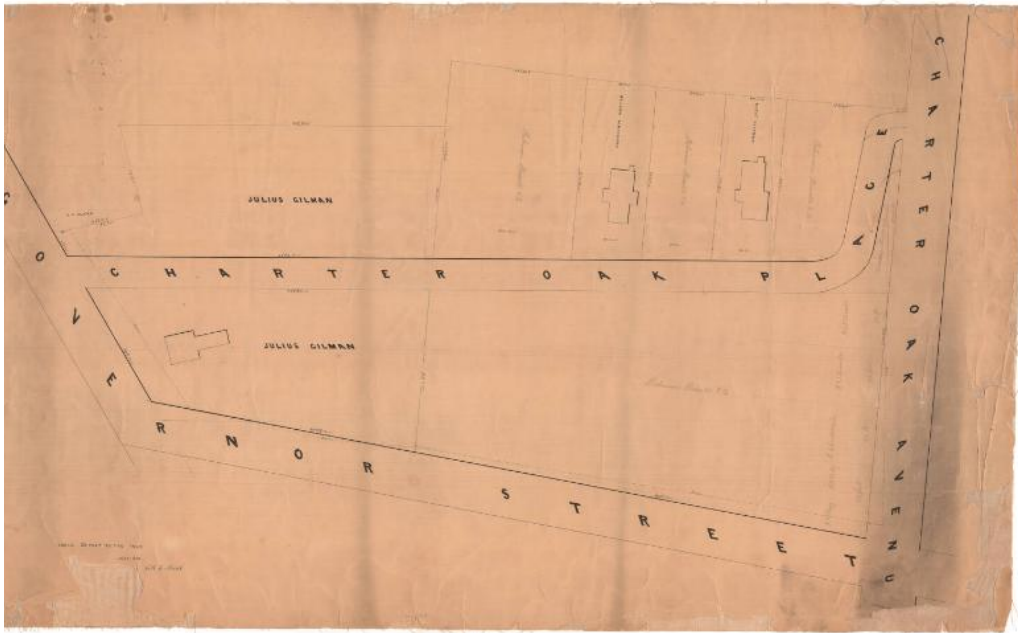

## Title Charter Oak Place, showing property of Julius Gilman and others

Date 1860

Primary Maker Seth E. Marsh

Medium Drawing; black ink and pencil on wove paper, lined with linen

Description Map of Governor Street, Charter Oak Place and Charter Oak Avenue in Hartford, Connecticut. Lots of land are depicted, with measurements in feet, showing the location and general shape of the buildings on them. Landowners include Julius Gilman, Robinson Bissell & Company, H. Kellogg, F.W. Cady, Nelson Kingsbury, and Nathaniel Shipman.

Dimensions Primary Dimensions (image height x width): 24 7/8 x 39in. (63.2 x 99.1 cm) Sheet (height x width): 24 7/8 x 41 5/8in. (63.2 x 105.7cm) Mount (height x width): 24 7/8 x 41 5/8in. (63.2 x 105.7cm)