

# Basic Detail Report

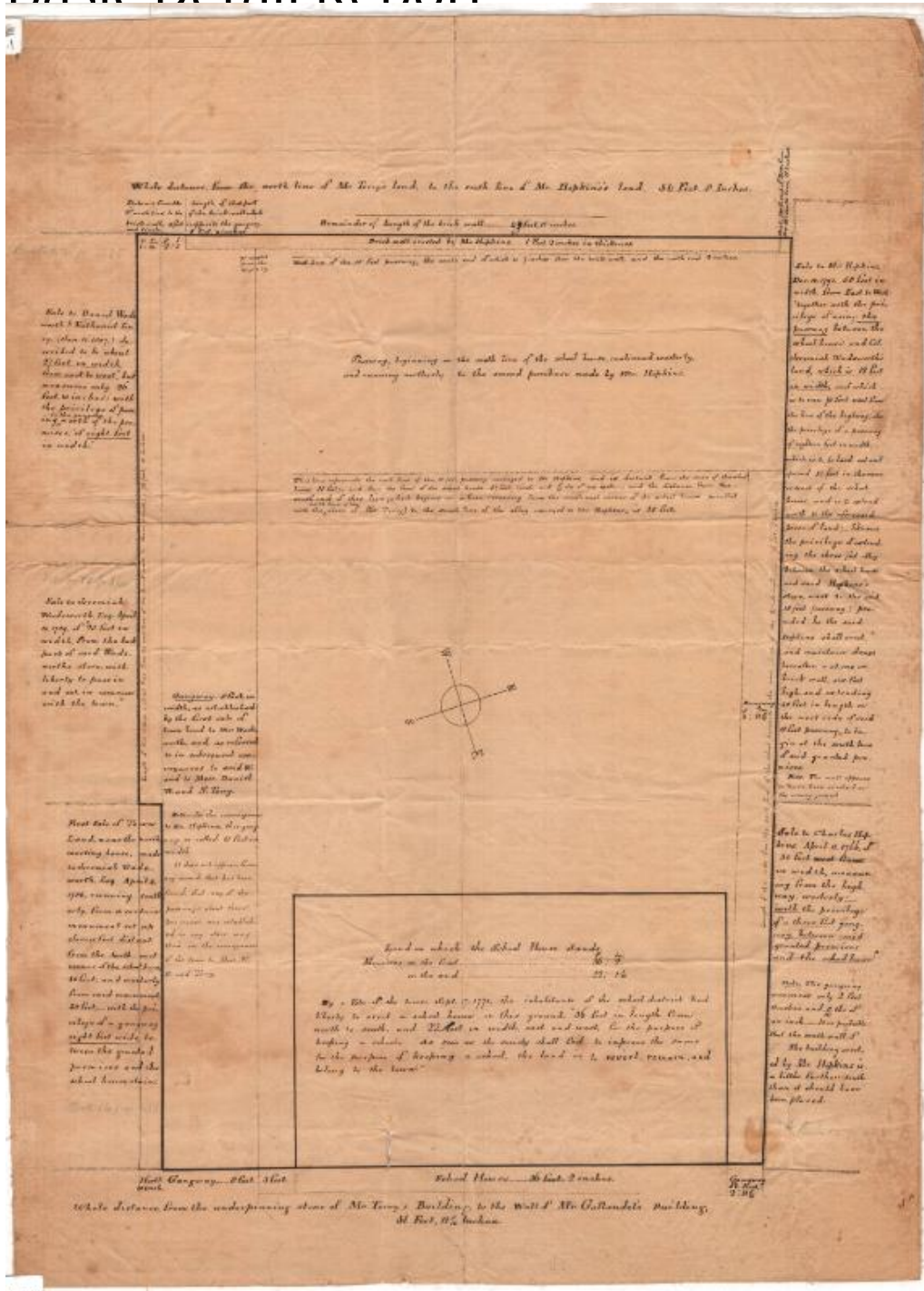

Title Land on Which the School House Stands

Date after 1807

Primary Maker Nathaniel Goodwin

Medium Drawing; black ink and pencil on paper, backed with linen

# Basic Detail Report

Description Manuscript map of the land where a schoolhouse stood in Hartford, Connecticut, including the property lines and measurements of the building, gangway and passway. The text around the map describes the history of the ownership of the schoolhouse land and the land around it.

Dimensions Primary Dimensions (image height x width): 19 1/4 x 13in. (48.9 x 33cm) Sheet (height x width): 26 1/8 x 19 1/8in. (66.4 x 48.6cm) Mount (height x width): 26 1/8 x 19in. (66.4 x 48.3cm)