

# Basic Detail Report

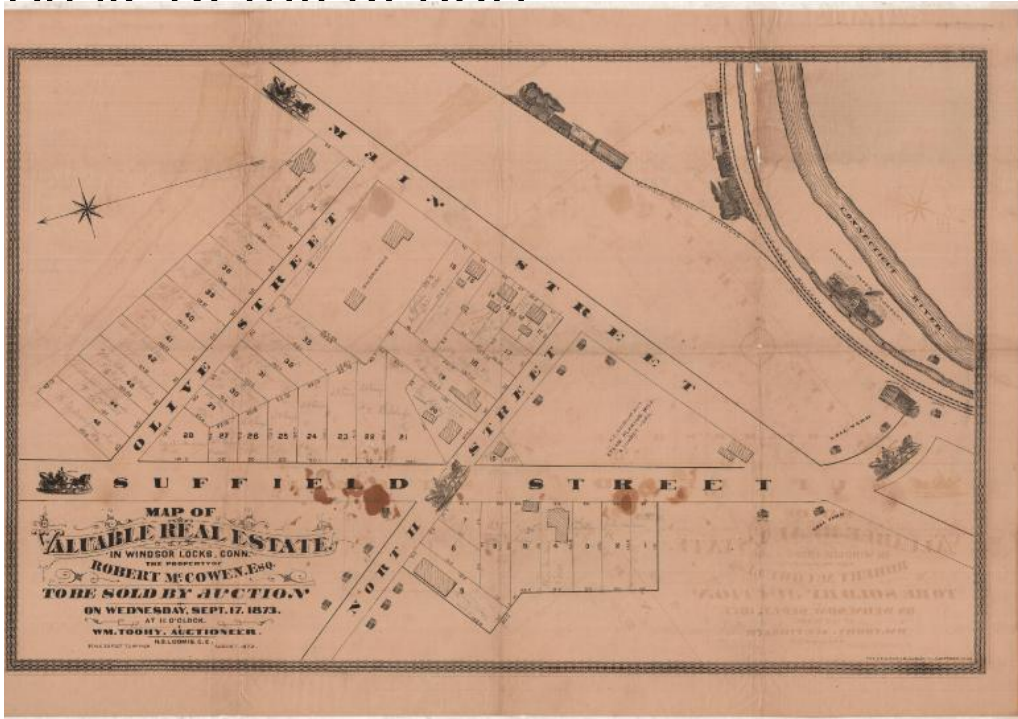

## Title Map of Valuable Real Estate in Windsor Locks, Connecticut

Date 1873

Primary Maker Hiram G. Loomis

Medium Lithography; black printer's ink on wove paper

Description Map of part of Windsor Locks, Connecticut, from Main Street to the north, the Connecticut River to the east, Suffield Street to the south, and Olive Street to the west. Numbered lots of land are depicted, with dimensions and, in some cases, shaded rectangles marking the locations of buildings. The Suffield Branch and New York, New Haven and Hartford Railroad lines are depicted running alongside the river, and are decorated with images of trains. Also running parallel to the river is the Enfield Falls Canal (not labeled), which is decorated with a vignette of the Seymour Paper Company. The roads depicted are accompanied by images of horse-drawn carriages.

# Basic Detail Report

Dimensions Primary Dimensions (image height x width): 21 1/2 x 33 1/2in. (54.6 x

85.1cm) Sheet (height x width): 24 1/8 x 35 1/4in. (61.3 x 89.5cm)