

Basic Detail Report

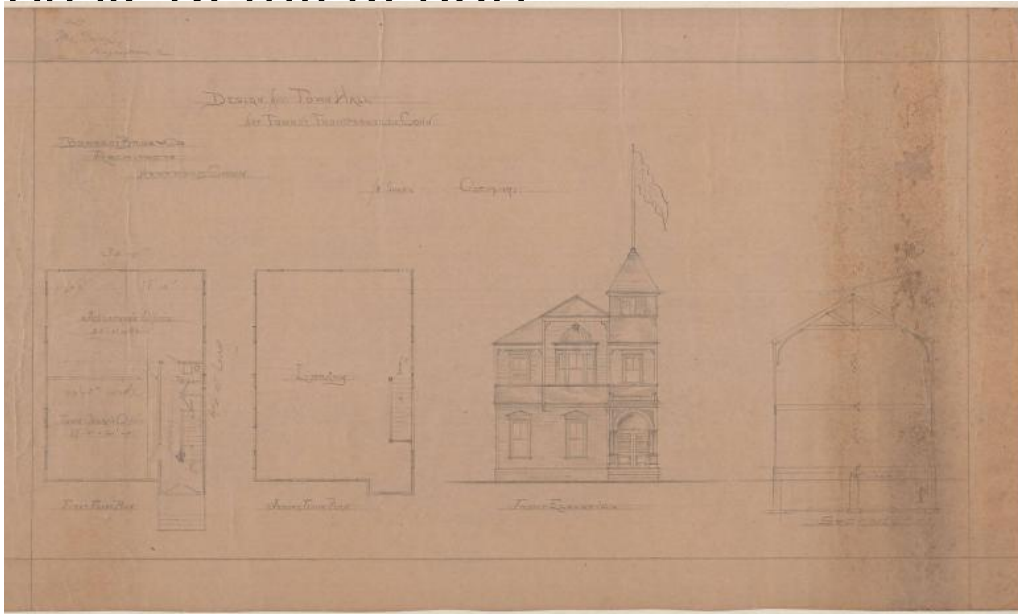

Title Town Hall, Enfield

Date 1891-1892

Primary Maker Barrett Bros.

Medium Architectural drawings, pencil on heavy paper

Description Plans for a two story colonial revival style building with gable roof, clapboard and shingle siding, featuring a three story towered entrance with conical roof and implied flag pole pinnacle. Also featured along the front elevation is an arched recessed entryway, supported by Doric columns, with raised paneled entry doors, and applied stick-work highlighting architectural elements. Windows on the building appear as double-hung plate glass sash windows, with detailed pediment lintels on the first story and corniced lintels on the second story. Also appearing is a large Palladian style window on the second story, and small double-hung six-over-one grouped sash windows on the tower third story. A total of two drawings comprise the set, showing the first and second floor plans, as well as front elevation and section details. The first story

Basic Detail Report

plan includes the recessed entry, a hallway, toilet, Town Clerk's Office, and

Selectman's Office. The second story plan includes an open floor plan labeled as a library.

Dimensions Sheet (height x width): 14 1/2 x 24in. (36.8 x 61cm)