

Basic Detail Report

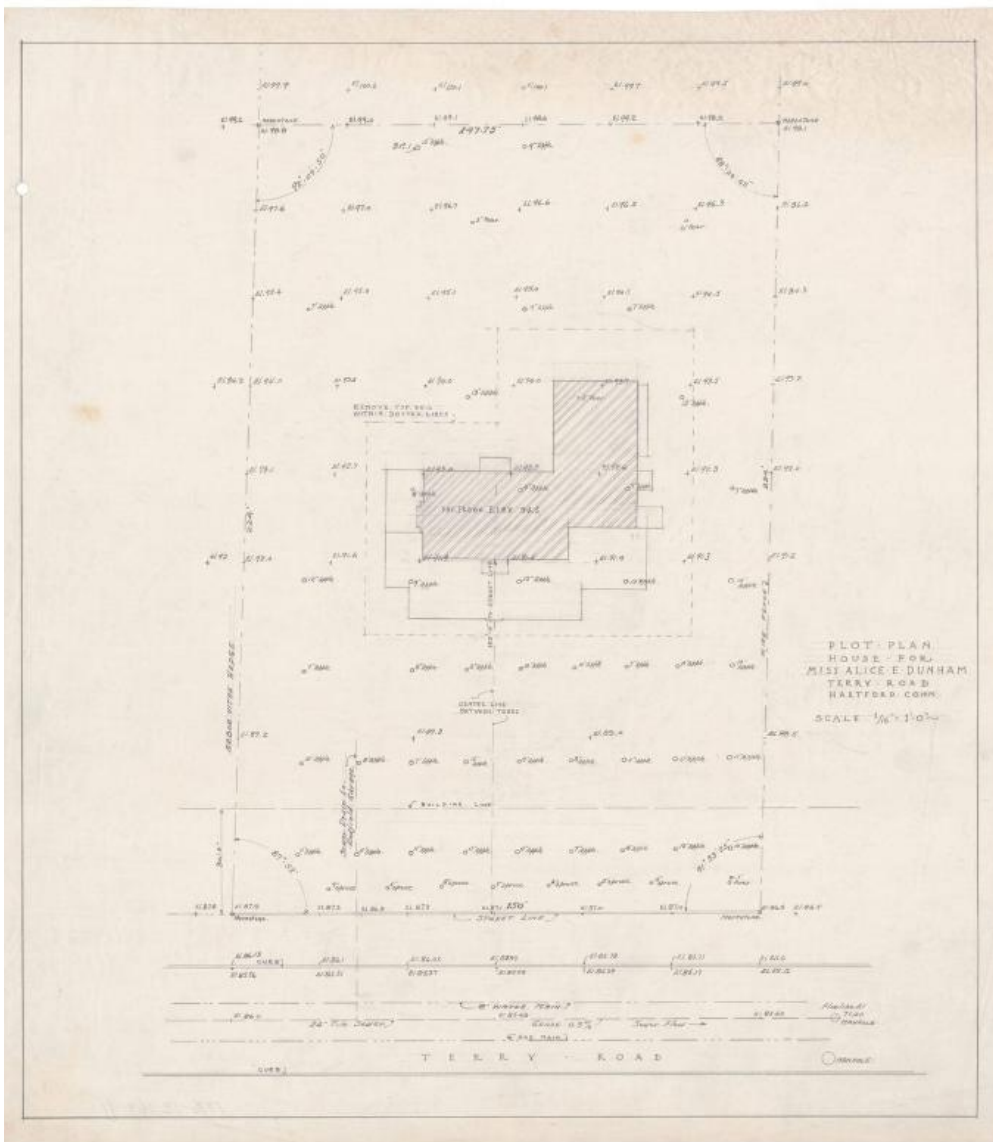

Title House for Alice E. Dunham, 111 Terry Road, Hartford

Date 1939

Primary Maker Smith & Bassette

Medium Architectural drawings, pencil, black and blue ink on linen paper

Description Three-story Colonial Revival house with attached two story garage.

The main house features a brownstone foundation, a Roman doric entry portico, brick-coursed exterior walls, copper gutters, stone and stuccoed cornice and a gable slate roof. The attached garage portion features a gambrel roof, with full

Basic Detail Report

brick-coursed exterior walls on the roof ends, otherwise it features full brick

coursing on the first story, and slate siding on the second. The garage has a

brownstone foundation, a pedimented side entry porch, copper gutters, stone

and stuccoed cornice, and slate roofing. Other notable exterior features include

an artisan copper roofed rear entry porch, and flagstone paved / brownstone

walled walkways and terraces. Windows are primarily double-hung sash

windows, in either the eight-over-eight, six-over-six, or four-over-four

configuration. The West Elevation also includes round and half round arch sash

windows. Nine drawings are included in the set: plot plan, west elevation and

section, west elevation, north elevation, front elevation as well as third floor and

garage details, second floor, first floor, and basement plans. The basement

plans include: a laundry room, toilet, store room, and boiler. The first floor plans

include: the garage, side entry porch, kitchen with attached pantry and servants

dining alcove, butler's pantry, dining room, rear porch, toilet, coat closet, hall,

entry alcove and porch, living room and a veranda. The second floor plans

include: two servant's rooms with separate bath and hall over the garage, as

well as, a long passageway connecting another bath and three chambers, one of

which features an ensuite bath, and private balcony. The third floor plans

include: a stairway to the hanging closet and attic storage space.

Dimensions Primary Dimensions (height x width): 20 1/2 x 24 1/2in. (52.1 x 62.2

cm)