

Basic Detail Report

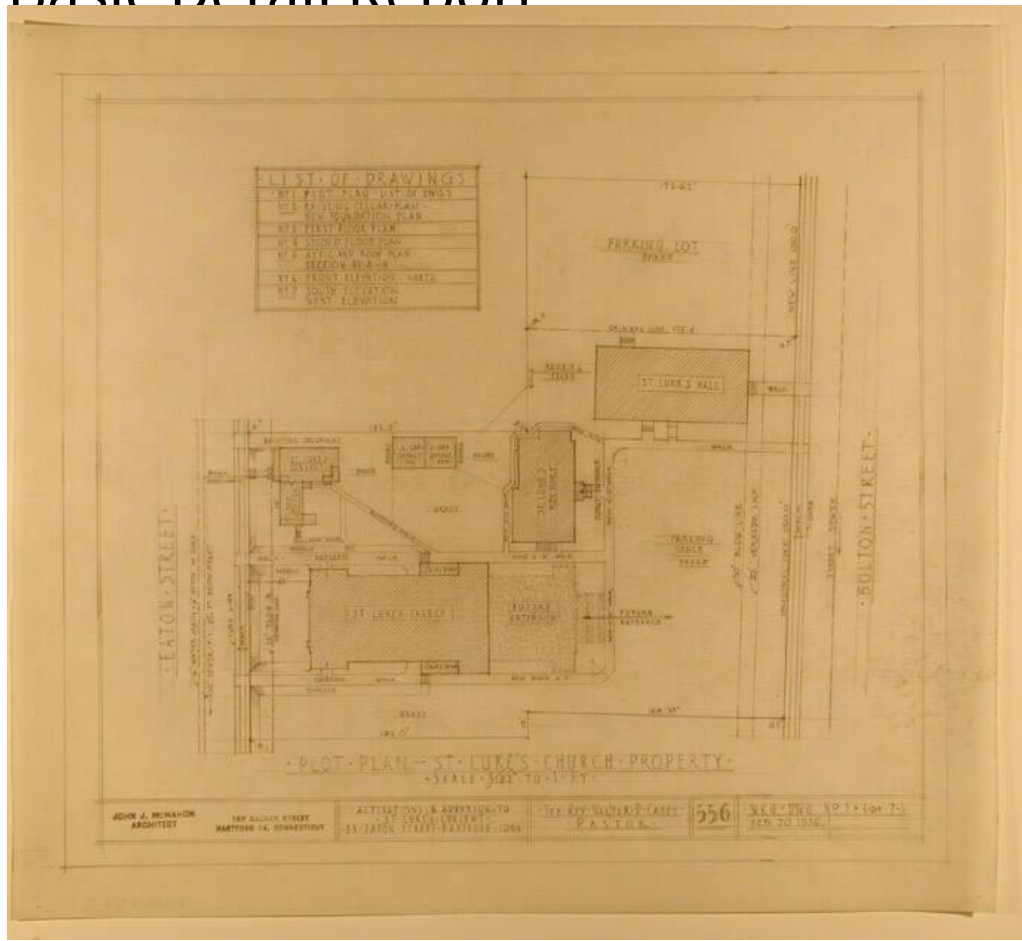

Title St. Luke's Church Alterations and Enlargements to Convent

Date 1956

Primary Maker John J. McMahon

Medium Drawings; pencil and colored pencil on paper. Blueprints; cyanotypes on paper.

Description Plans, elevations, and sections showing additions and alterations to church buildings and property. Existing features and proposed changes are noted for the foundation, cellar, chapel, sanctuary, community room, nun's rooms, parlor, sewing room, kitchen and dining rooms, enclosed veranda and porch, bathrooms, closets, halls, and stairways. A connecting walkway is indicated between the convent and church. Two preliminary pencil sketches are

Basic Detail Report

included, one showing the second floor plan with nun's rooms, and another

showing the attic floor with two rooms, cedar closet, deck, and roof.

Dimensions Primary Dimensions: 16 1/4 x 19 1/2in. (41.3 x 49.5cm) Sheet: 21 1/4

x 27 1/2in. (54 x 69.9cm)