

Basic Detail Report

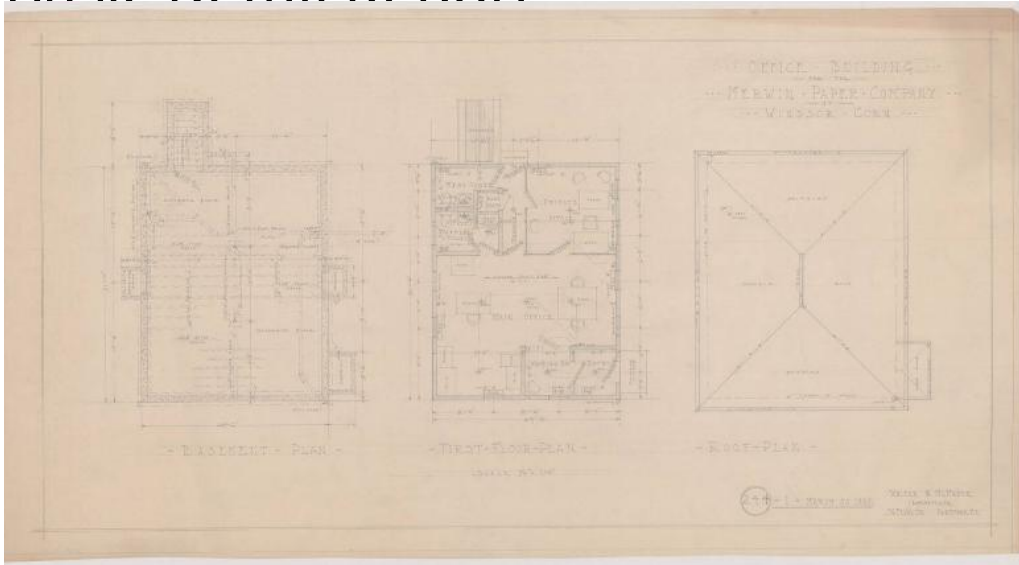

Title Merwin Paper Company Office Building

Date 1920

Primary Maker John J. McMahon

Medium Drawings; pencil on paper

Description Drawings include plans for the office building's basement, first floor, roof, and elevations for north, south, east, west sides, and a cross-section. Also included are plans for mill's basement and floor, and elevations for north, south, east and west sides. The office building's plans include concrete basement floor, main office, private office, waiting room and shingle roof. Elevations include double-hung sash, clapboards, wood brackets at entrance, hip roof and entrance on first of five bays with hip pediment. Section drawings include bracing, wood panels and cobblestones. The mill's plans include truss locations while the elevations show joinery locations, eight bays, pivoting sash windows on the basement level, ruberoid roof, and notes on removing present windows.

Dimensions Sheet (height x width): 39 x 17 1/4in. (99.1 x 43.8cm)