

Basic Detail Report

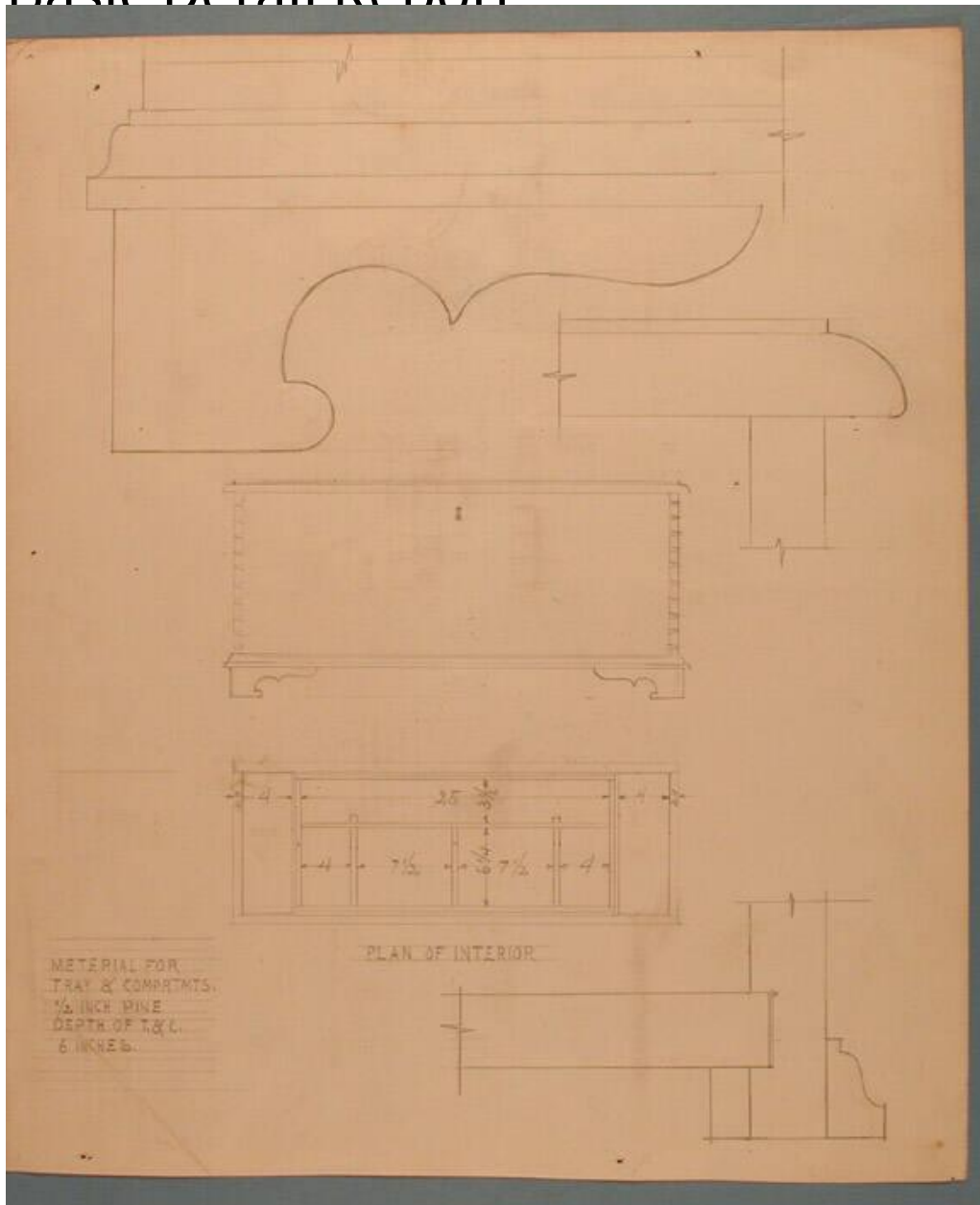

Title Tablet and Sketchbooks of Furniture Details and Miscellaneous

Drawings

Date 1946-1996

Medium Graphite and ink on paper with cardboard

Basic Detail Report

Description Two tablets and one sketchbook of drawings by Paul Koda. Subject

matter of drawings includes: Nielson secretary Thomas & Hoadley Tall Clock

Woodworker's Toolchest Sperm whale Miscellaneous furniture drawings and

details

Dimensions Sheet (height x width or smaller): 17 x 14in. (43.2 x 35.6cm)